

Raccordi per guaine LFNC-B

Fittings for LFNC-B conduits

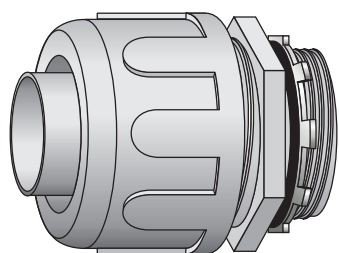

Impiego - Use

Raccordi costruiti in poliammide PA6 libero da alogeni per guaine rinforzate LFNC-B.

Fittings made of halogen-free PA6 polyamide for LFNC-B reinforced conduits.

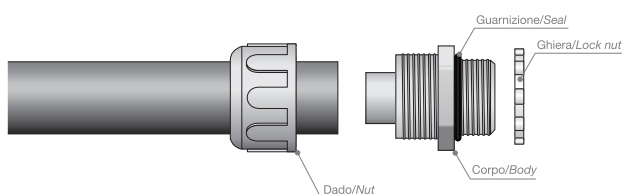

Dati Tecnici - Technical data

Caratteristica - Characteristics	Valore/proprietà - Value/property
Costruzione <i>Construction</i>	Raccordi costituiti da 4 elementi: corpo, dado di bloccaggio, ghiera, guarnizione <i>Fittings made of 4 parts: body, counter nut, lock nut, sealing gasket</i>
Materiale <i>Material</i>	Dado di bloccaggio e corpo in poliammide PA6 libero da alogeni, ghiera in acciaio zincato <i>Counter nut and body are made of halogen-free PA6 polyamide, lock nut made of galvanized steel</i>
Temperatura minima di esercizio <i>Minimum working temperature</i>	-40°C
Temperatura massima di esercizio <i>Maximum working temperature</i>	+120°C
Grado di protezione <i>Protection class</i>	IP67
Guaine compatibili <i>Compatible conduits</i>	LFNC-B
Colore <i>Color</i>	Grigio <i>Gray</i>

Codifiche e dimensioni - Coding and dimensions

Raccordo diritto maschio - Straight male fitting

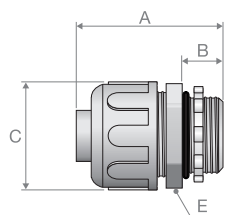

Codice <i>Code</i>	Versione <i>Version</i>	Filetto <i>Thread</i>	Dimensione guaina <i>Conduit size</i>	Passaggio utile <i>Min. internal bore [mm]</i>	Dimensioni <i>Sizes [mm]</i>				Confezione <i>Packaging [pz]</i>
					A	B	C	E	
AN263.312.0	NPT	1/2"	3/8"	10,9	47	14	35	33	25
AN263.316.0	NPT	1/2"	1/2"	14,4	47	14	35	33	25
AN263.320.0	NPT	3/4"	3/4"	18,0	49	16	43	39	10
AN263.326.0	NPT	1"	1"	23,9	53	16	49	44	5
AN263.335.0	NPT	1 1/4"	1 1/4"	30,6	60	18	59	55	5
AN263.340.0	NPT	1 1/2"	1 1/2"	35,4	64	19	66	61	1
AN263.350.0	NPT	2"	2"	47,8	72	21	83	79	1

Raccordo maschio 90° - 90° male fitting

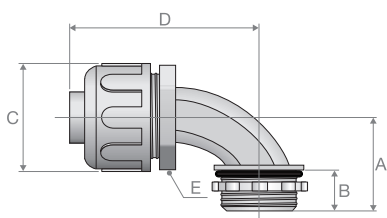

Codice Code	Versione Version	Filetto Thread	Dimensione guaina Conduit size	Passaggio utile Min. internal bore [mm]	Dimensioni Sizes [mm]					Confezione Packaging [pz]
					A	B	C	D	E	
AN263.412.0	NPT	1/2"	3/8"	10,9	30	13	35	60	31	10
AN263.416.0	NPT	1/2"	1/2"	14,4	30	13	35	60	31	10
AN263.420.0	NPT	3/4"	3/4"	18,0	40	14	43	68	37	10
AN263.426.0	NPT	1"	1"	23,9	50	16	49	82	45	5
AN263.435.0	NPT	1 1/4"	1 1/4"	30,6	68	18	59	84	54	5
AN263.440.0	NPT	1 1/2"	1 1/2"	35,4	70	19	66	88	59	1
AN263.450.0	NPT	2"	2"	47,8	73	21	83	90	74	1